



Wave Cyber state-of-art membrane pressure vessels are manufactured by computer-controlled filament winding machine and associated high performance processing equipments. Based on the high speed and precision manufacturing process provided by these machines and skillful technical personnel, a range of quality products are made. Wave Cyber can meet the increasing demand for high quality membrane pressure vessels through in house quality assurance program. Customers are now save time and maintenance costs as well as faster membrane

Design features

- Credible simple configuration
- Decrease 30% parts
- Down stream thrust core fixed membrane elements into place.
- Unique 1" half union end permeate port design
- More reliable side port design
- Safety bolt
- Heavy duty Aluminium bearing plate design to ASME requirement.
- Three turns retaining lock ring and reliable Stainless steel reinforced retaining groove assures durable operation.

Quality Assurance

Wave Cyber has committed to provide most reliable and quality assurance and best customer service. All Wave Cyber membrane pressure vessel products are designed to a staggering 100,000 cycles and qualified test to six times of its rated operating pressure.

Wave Cyber builds most safe and durable membrane pressure vessels to meet customers' requirements. All of our employees embrace our quality system standards and are active participants in our continual improvement program. We continue to strive for perfect

8" Membrane Pressure Vessel

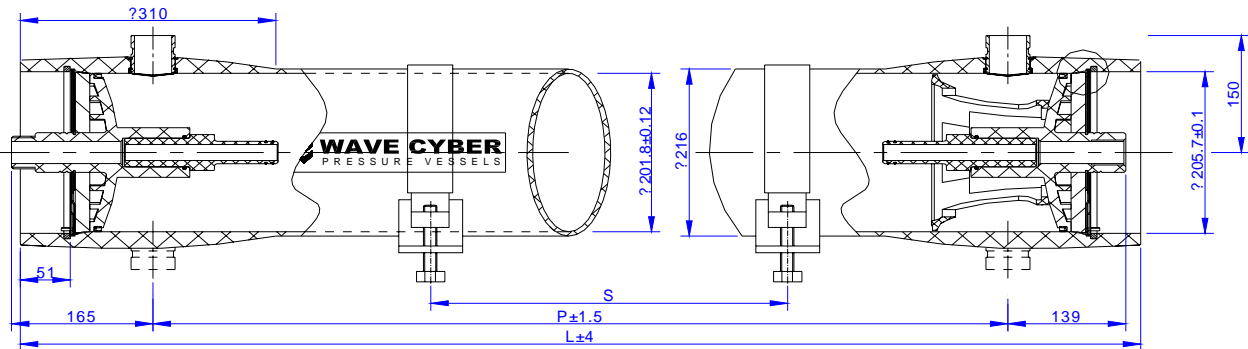

SPECIFICATION – 300 PSI side port vessel

Model No.	L * INCH (MM)	P INCH (MM)	S INCH (MM)	EMPTY WEIGHT * POUND (KG)
Wave-P-8-1	58.7(1491)	47(1194)	1@28(711)	76(35)
Wave-P-8-1.5	78.7(1999)	67(1702)	1@42(1067)	89(40)
Wave-P-8-2	98.7(2507)	87(2210)	1@56(1422)	102(46)
Wave-P-8-3	138.7(3523)	127(3226)	1@80(2032)	128(58)
Wave-P-8-4	178.7(4539)	167(4242)	2@64(1626)	154(70)
Wave-P-8-5	218.7(5555)	207(5258)	2@78(1981)	180(82)
Wave-P-8-6	258.7(6571)	247(6274)	2@92(2337)	205(93)
Wave-P-8-7	298.7(7587)	287(7290)	2@106(2692)	231(105)
Wave-P-8-7.5	318.7(8059)	307(7798)	2@114(2896)	244(111)
Wave-P-8-8	338.7(8603)	327(8306)	2@120(3048)	257(117)

* Please refer to technical drawing for dimension and empty weight of specific vessel of specific pressure rating

SIZE INFORMATION

Pressure rating:

Side port vessels(PSI): 75,150,300,450,600,1000

End Port vessels(PSI): 75,150,250,300,400,600,1000

Other pressure ratings are available on request

Feed port size:

Side Port vessels: 1¹/₂", 2", 2¹/₂" Victualic

End Port vessels: 1¹/₂" Victualic

Length available:

1, 1.5, 2, 3, 4, 5, 6, 7, 7.5, 8 Elements

Permeate port size:

Standard 1.5" Female thread (1" soc union adaptor); other options as 1.25"NPT Male thread; 1"NPT female thread and 1" Rp female thread are available.

FOR MORE INFORMATION PLEASE CONTACT

WAVE CYBER (Shanghai) Co., LTD.

2 SongChun Road, SongZe Industrial Zone, Shanghai New city, Qingpu District, Shanghai 201703 China. Tel: 86-21-6975-8588 Fax: 86-21-6975-8288

webmaster@wave-cyber.com

jim@wave-cyber.com